



Leisuretime Pool Pump

“ The range of Leisure Time pool pumps have been purposefully designed to provide maximum performance and corrosion resistance at a realistic cost. ”

Self-Aligning Barrel Unions

Onga's unique 5 degree self-aligning barrel unions make pipework connection a breeze.

Electrical approvals

Rest easy knowing your Leisure Time pool pump has passed all stringent Australian Standards for safety and is approved for installation within the wetted zone of the pool area.

Elevated motor foot

Incorporating an elevated mount into the pump design keeps moisture well away from the motor.

Corrosion resistant endshield

Unique electro-phoretic plated cast iron endshield for better corrosion protection extending the life of the pump.

Large hair and lint pot with see through lid

Easy to clean large hair and lint pot with a clear lid so you can check at a glance whether or not it is full.

Low friction lint pot O-ring

Having a low friction teflon impregnated self-lubricating O-ring on the lint pot means you only need to tighten the lid by hand. No tools are necessary and because you only tighten by hand, removing the lid is also a simple task.



Leisuretime Pool Pump



Operating Conditions

Suitable for pumping clean non-aggressive liquids without solids or fibres in suspension.

Fluid:	Water
Maximum working pressure:	270 kPa
Water temperature range:	5°C-40°C
Ambient temperature:	55°C maximum

Motor

Type:	TEFC 2 pole
Nominal speed:	2900 rpm
IP rating:	IPX55
Insulation class:	Class F
Thermal overload:	Internal
Frequency:	50Hz*
Voltage:	230-240*
Bearing type:	Deep groove ball bearing with double contact lip seal
Bearing temperature rating:	150°C

Materials

Component	Material
Pump casing:	Glass filled ABS
Clacker:	Polypropylene
Impeller:	Glass filled ABS
Baffle:	Glass filled ABS
Drain plug:	Polypropylene
Diffuser:	Glass filled ABS
Basket:	HD polyethylene
Shaft sleeve:	Nylon
Motor shaft:	K-1137 steel
End shield:	Double zinc coated cast iron
Hair and lint pot O-ring:	Nitrile
O-rings:	Low friction nitrile
Barrel unions:	ABS
Hair and lint pot lid:	Polycarbonate
Mechanical seal, 1/2" type 6 (LTP1100 3/4"):	
Flexible bellows:	Nitrile
Stationary face:	Ceramic
Rotating face:	Carbon
Spring:	304 stainless steel

Performance Chart

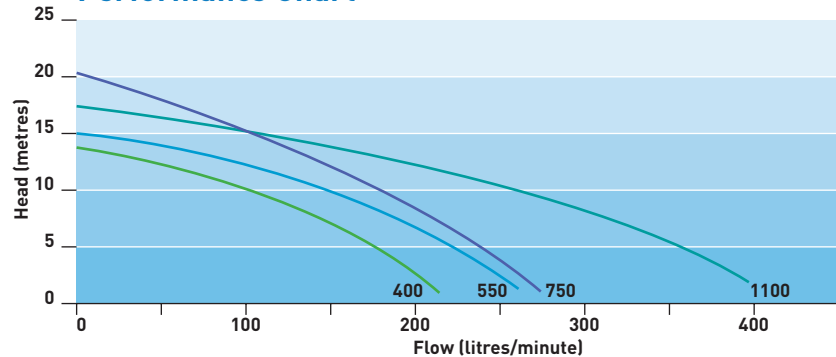

Dimensions

Model	LTP400	LTP550	LTP750	LTP1100
A	535mm	535mm	535mm	583mm

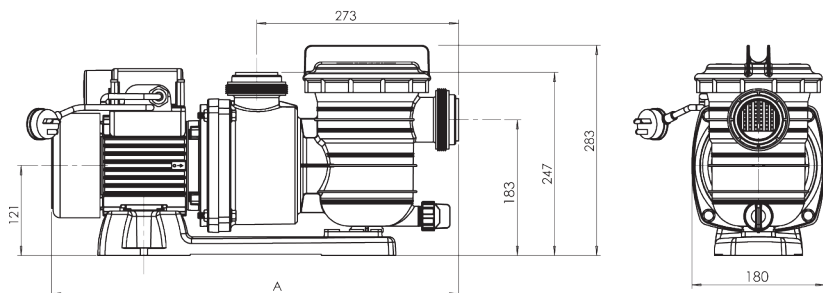

Model Data

Pump Model	Motor Kw (hp)	Supply Voltage	Phase	Full Load Current (A)	Full Rotor Current (A)	Capacitor mfd	dB(A)*	Supply Cord Length (m)	Net Weight (kg)	Packed Weight (kg)	Carton Dimensions L x W x H (mm)
LTP400	0.4 (1/2)	230-240	1	2.7	10	12	60	2	10.5	12	610 x 190 x 305
LTP550	0.5 (3/4)	230-240	1	3.5	17	20	59	2	12.5	14	610 x 190 x 305
LTP750	0.75 (1)	230-240	1	4.3	17	20	64	2	12.5	14	610 x 190 x 305
LTP1100	1.1 (1 1/2)	230-240	1	5.4	23	25	65	2	13.5	15	610 x 190 x 305

* dB(A) @ 1 metre



AVAILABLE FROM:

Head Office

Pentair AU/NZ:

1-21 Monash Drive,
Dandenong South, Vic 3175

Australia

National Customer Service: Phone: 1300 137 344

Fax: 1800 006 688

National Dealer Locator: Phone: 1800 664 266

Email: au.sales@pentair.com

Web: www.pentair.com.au

New Zealand

National Customer Service: Phone: 0800 654 112

Fax: 0800 806 642

National Dealer Locator: Phone: 0800 664 269

Email: nz.sales@pentair.com

Web: www.pentair.co.nz

International Australia/New Zealand

Phone: +61 3 9709 5800

Fax: +61 3 9709 5888

pumps / filters / heaters / heat pumps / automation / lighting / cleaners / sanitizers / water features / maintenance products

©2012 Pentair Aquatic Systems. All rights reserved.

Display, publication, modification or distribution is strictly prohibited without the prior written permission of Pentair Water Pty Ltd.
Disclaimer: Every endeavour has been made to publish the correct details in this publication. No responsibility will be taken for errors, omissions or changes in product specifications. Pentair reserves the right to change specifications.